



Status: Active
Property Sub-Type: Single Family
Sub-Type: Detached
Minimum Age:
County: Ocean
Municipality: Seaside Park (SEP)
Area/Section: Seaside Park
Complex/Subdivision: None
Apx Lot Dimensions: 50 x 98
Acresage:
Elementary School:
Middle School:
High School:
Other Elementary:
Other High:
Style: Shore Colonial
Model:
Zoning: Residential
List Price: \$725,000
Apx Year Built: 1954
Apx SqFt: 1,960
Basement: Yes
Rooms: 7
Bedrooms: 4
Baths: 1 / 1
FP / #: / 1
Garage / #: No / 0
Waterfront: No
Waterview: No
Handicap Access:
Directions: South on Central Avenue Left onto C Street

Location! Location! Location! 65 years of memories were made at this beach house. Walk into the sun drenched porch first and then explore the rest. There are 4 spacious bedrooms, eat in kitchen, and living room. Large basement which is great for rainy day play time for the kiddies. Call for a showing today.

Tax Year: 2018	Asmnt - Total: 701,400	New Construction:	Deed Restricted:
Taxes: 9,749		Farm:	Farm Assessed:
Special Assessment:		Assessment Status: Assessed	
Assn Fee:	Mgmt Type:	Fee Includes:	App Escrow Required:
Assn Fee Paid:	Common Elements:		

Room Name	Level	Dimensions	Room Name	Level	Dimensions
Bedroom	First				
Bedroom	Second				
Bedroom	Second				
Kitchen	First		Basement	Basement	
Living Room	First				
Bathroom	First				
Laundry	First				
Master Bedroom	First				
Sunroom	First				

Ownership Type: Master
Bath:
Basement: Bilco Style Doors; Full; Unfinished
Dining Room:
Energy Features:
Exterior: Fence; Outdoor Lighting; Outdoor Shower; Patio; Porch - Enclosed; Storm Door(s)
Floors: Linoleum/Vinyl; Wood
Foyer: Floor - Wood
Great/Family Room:
Heat/AC: Central Air; HWBB
Included: Ceiling Fan(s); Dishwasher; Dryer; Gas Cooking; Light Fixtures; Outdoor Lighting; Refrigerator; Stove; Washer
Excluded: furnishings

Financing:
Heat Fuel: Electric
Interior:
Kitchen: Floor - Linoleum/Vinyl
Lot Description: Fenced Area; Oceanside
Living Room: Floor - Wood
Master Bedroom: Floor - Wood
Out Buildings: Storage Shed
Parking: Driveway; Off Street; On Street

Pool:
Roof: Shingled
Siding: Vinyl
Special Needs:
Style: Shore Colonial
Water Heater: Natural Gas
Water/Sewer: Public Sewer; Public Water

Days On Market: 15

photo (35)



photo (4)



photo (7)



photo (8)



photo (6)



photo (5)



photo (20)



photo (21)



photo (9)



photo (10)



photo (11)



photo (12)



photo (15)



photo (16)



photo (22)



photo (23)



photo (24)



photo (32)



photo (33)



photo (31)

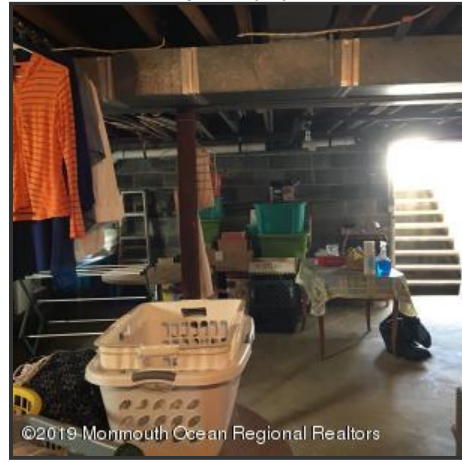

photo (27)



photo (29)



photo (30)

